

Save This Manual For
Future Reference

SEARS

**owners
manual**

**MODEL NO.
113.797831
113.796812**

LINE

Serial
Number _____

Model and serial
number may be found
at the rear of the housing.

You should record both
model and serial number
in a safe place for
future use.

CAUTION:

Read **GENERAL** and
ADDITIONAL SAFETY
INSTRUCTIONS
carefully

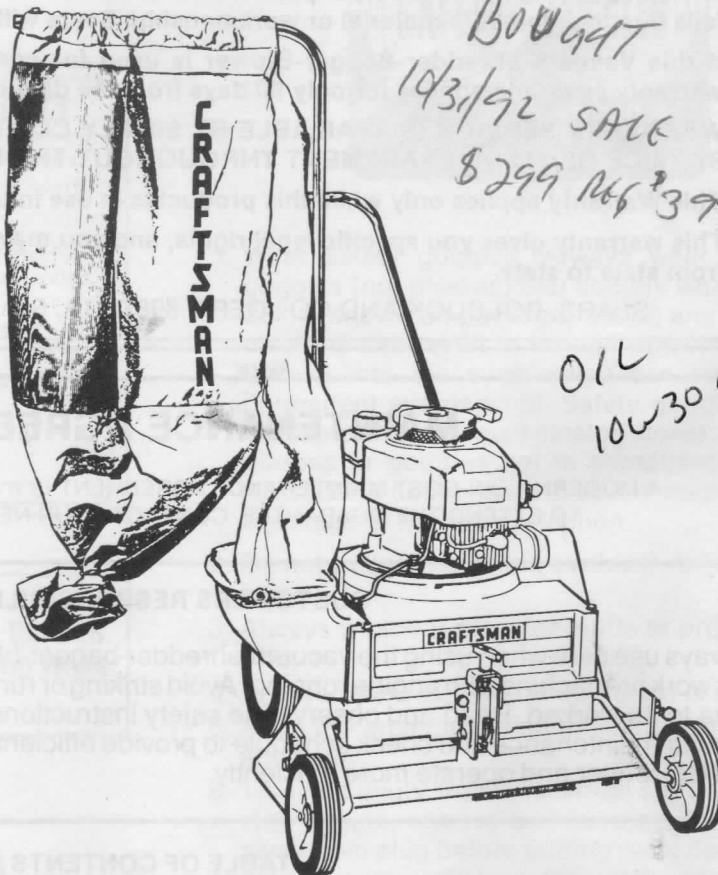

MODEL 113.797831 SHOWN

SEARS
CRAFTSMAN

**VACUUM -
SHREDDER -
BAGGER -
BLOWER**

- assembly
- operating
- repair parts

Sold by SEARS, ROEBUCK AND CO., Chicago, IL. 60684 U.S.A.

FULL ONE YEAR WARRANTY ON CRAFTSMAN VACUUM-SHREDDER-BAGGER-BLOWER

If within one year from the date of purchase, this Craftsman Vacuum-Shredder-Bagger-Blower fails due to a defect in material or workmanship, Sears will repair it, free of charge.

If this Vacuum-Shredder-Bagger-Blower is used for commercial or rental purposes, this warranty coverage applies for only 90 days from the date of purchase.

WARRANTY SERVICE IS AVAILABLE BY SIMPLY CONTACTING THE NEAREST SEARS SERVICE CENTER/DEPARTMENT THROUGHOUT THE UNITED STATES.

This Warranty applies only while this product is in use in the United States.

This warranty gives you specific legal rights, and you may also have other rights which vary from state to state.

SEARS, ROEBUCK AND CO., DEPT. 698/731A, Sears Tower, Chicago, IL 60684

MAINTENANCE AGREEMENT

A MODERN, LOW-COST MAINTENANCE AGREEMENT IS AVAILABLE ON THIS PRODUCT TO EXTEND THE GUARANTEE. CONTACT YOUR NEAREST SEARS STORE.

CUSTOMERS RESPONSIBILITIES

Always use care when using the vacuum-shredder-bagger-blower. Keep clear of moving parts. Do not work on machine with engine running. Avoid striking or running into solid objects or debris in the area to be worked. Read and observe the safety instructions. Keep the machine clean. Follow a regular maintenance and check schedule to provide efficient operation. A well-cared for machine will last longer and operate more efficiently.

TABLE OF CONTENTS

	Page		Page
WARRANTY	2	Fueling/Refueling	10
SAFETY INSTRUCTIONS	2	Priming The Engine	10
GETTING TO KNOW YOUR VACUUM- SHREDDER-BAGGER-BLOWER	4	To Start Engine	11
UNPACKING AND CHECKING CONTENTS	5	OPERATING INSTRUCTIONS	11
ASSEMBLY	5	Power Brush Operation	11
Attaching Handle	5	Emptying Bag	11
Attaching Bag Hanger	6	Removing Shredder Grille	12
Attaching Bag	6	Using Machine As Blower	12
Attaching Discharge Elbow	7	SERVICE INSTRUCTIONS	13
Attaching Bag to Discharge Elbow	8	Oil Changing	13
Power Brush Adjustment	8	Air Filter	14
OPERATING CONTROLS	9	Check Spark Plug	15
Handle Height Adjustment	9	Storage Instructions	15
Snout Height Adjustment	9	Brush Replacement	16
ENGINE OPERATION	10	Drive Belt Replacement	16
Important... Before Starting Engine	10	TROUBLE SHOOTING	17
		REPAIR PARTS	20

safety instructions for Vacuum-Shredder-Bagger-Blower

WARNING:

TO AVOID MISTAKES THAT COULD RESULT IN SERIOUS, PERMANENT INJURY, DO NOT START YOUR VACUUM SHREDDER BAGGER UNTIL THE FOLLOWING STEPS HAVE BEEN SATISFACTORILY COMPLETED.

ASSEMBLY

1. Learn the function and proper use of the stop-run control, handle, bag hanger and support, starter handle, height adjustment, discharge elbow and spring attachment, grille and pin, blower deflector, bag, oil and gas filter cap, oil drain plug, spark plug and wire.

2. Read and understand all safety instructions and operating procedures throughout the manual.
3. Read the following labels which appears on the front of the shredder.

DANGER FOR YOUR OWN SAFETY:

Read and Understand Owner's Manual Before Operating Machine. Know the Machine's Controls and Adjustments.

1. Stop engine and remove spark plug wire from spark plug before:
 - a) Removing or installing grille pin or grille.
 - b) Removing or installing discharge elbow or deflector.
 - c) Refueling, adding oil or leaving machine unattended.
 - d) Putting hand or foot into intake or outlet.
2. Always operate machine with elbow and bag or deflector installed.
3. Always wear ear plugs or muffs and eye goggles complying with ANSI Z87.1.
4. Keep people and pets away from area of operation.
5. Do not operate without guards in place.
6. Shut off engine before emptying bag.

815806B

DANGER: ROTATING CUTTING BLADES.
Keep Hands and Feet Out of Inlet Opening While Machine is Running.



BEFORE EACH USE

- A. Inspect your vacuum-shredder-bagger-blower. If any parts are missing, bent, or fail in any way, switch the engine to the stop position, remove the wire from the spark plug and replace damaged, missing or failed parts before using the machine. Inspection should include impeller and grille.
- B. Remove all visible foreign objects such as rocks, toys, metal, bones, rags, etc. from the area where the machine is to be used.
- C. Make only adjustments as outlined in this manual.
- D. Check fuel and oil before starting engine. Do not fill the gasoline tank indoors or when the engine is running. Allow a hot engine to cool several minutes before filling gasoline tank. Clean off any spilled gasoline before starting the engine.



1. Wear safety goggles. Always wear safety goggles (not glasses) that comply with ANSI Z87.1 (shown on package). Using any power machine can result in foreign objects being thrown into the eyes which can result in permanent eye damage. Safety goggles are available at Sears retail catalog stores. Use of glasses or goggles not in compliance with ANSI Z87.1 could result in severe injury from breakage of the eye protection.
2. Do not wear loose fitting clothing - tie back long hair.
3. Always wear ear plugs or muffs to protect your ears.
4. Always wear respirator if operation is dusty.
5. Keep the area of operation clear of all persons and pets.
6. To avoid injury from accidental starting, always stop engine, remove and keep spark plug wire away from plug before putting hand, feet, tool or any other foreign object into intake or discharge openings.
7. Stop the engine before crossing areas of loose gravel or similar debris otherwise the debris could be picked up and thrown by the impeller causing injury.
8. Shut the engine off and wait until the impeller comes to a complete stop before emptying bag.
9. Do not use without discharge device in place.
10. To avoid injury from thrown rocks or similar debris, always use the blower deflector and adjust pick up snout to high position when operating as a blower.
11. When operating as a shredder-bagger always use the elbow and bag. Keep grille in place whenever possible.
12. Shut off engine, turn engine control to "stop" and remove spark plug wire before removing or replacing grille pin, grille, discharge elbow, or blower deflector or to clean brush.
13. If blockage or jam occurs turn engine control to "stop" position and remove spark plug wire before clearing the blockage or jam.
14. Engine and muffler can get very hot. Keep hands and inflammable material away.
15. Always operate with guards in place.
16. Do not operate equipment when barefoot or wearing open sandals. Always wear suitable work shoes.

safety instructions for Vacuum-Shredder-Bagger-Blower

OPERATION

- A. Never let children or any person unfamiliar with the use of the shredder bagger use the machine.
- B. Protect your eyes, hands, feet, face and ears.

DANGER: KEEP HANDS AND FEET OUT OF DISCHARGE AND INTAKE OPENINGS WHILE MACHINE IS RUNNING.

- C. Before leaving machine unattended, move the engine control to "stop".
- D. Always be sure of your footing; keep a firm grip on the handle and walk, never run.
- E. To maintain firm control of the machine against tipping or run-away, always move across the face of slopes with bag on uphill side. Never run machine up and down slopes.
- F. Do not run engine indoors. Exhaust contains odorless and deadly poison carbon monoxide.
- G. If the machine should start to vibrate abnormally, stop the engine, disconnect the spark plug wire

and correct the problem before resuming operation.

- H. Never let machine pick up a cloth or rag of any kind. This can do permanent damage to the impeller. If it ever occurs, stop machine immediately, remove spark plug wire and inspect impeller and grille for bending or cracks. Replace parts as indicated before proceeding to operate machine.

- I. Be sure oil level is full before using. Machine is shipped without oil in the reservoir.

MAINTENANCE AND STORAGE

- A. Never store the machine with gasoline in the tank inside a building where fumes may reach an open flame or spark. Allow the engine to cool before storing in any enclosure.
- B. To reduce fire hazard, keep the engine free of grass, leaves or excessive grease.
- C. Check bag frequently and replace worn bags.
- D. For any adjustments or repair not described in this manual, call the nearest Sears, Roebuck & Co. retail or catalog sales store.

getting to know your Vacuum-Shredder-Bagger-Blower

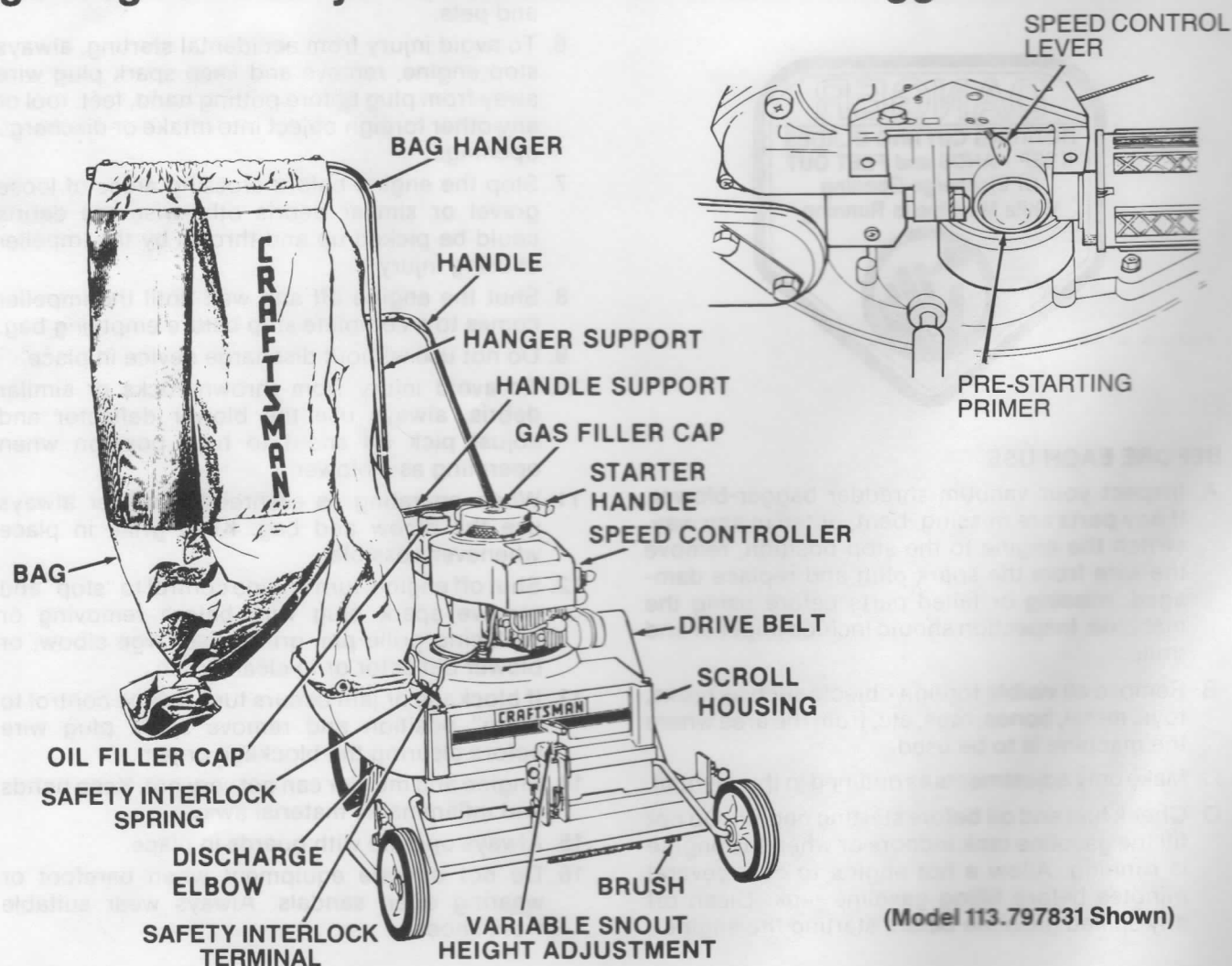

engine operation

IMPORTANT: BEFORE STARTING ENGINE

1. Place unit on level surface.
2. Remove oil cap/dipstick.
3. Using Sears SAE10W30 or 30W oil, slowly fill crankcase with 15 oz. of oil for Model 113.797831 and 21 oz. of oil for Model 113.796812. Then check dipstick and add additional oil if required.
4. Reinstall the oil cap/dipstick.

NOTE: Change oil after first 2 hours of operation and every 25 operating hours thereafter. Check oil every 5 operating hours, and before each use.

FUELING/REFUELING

WARNING: CHECK FUEL BEFORE STARTING ENGINE. DO NOT FILL THE GASOLINE TANK INDOORS OR WHEN THE ENGINE IS RUNNING. ALLOW A HOT ENGINE TO COOL SEVERAL MINUTES BEFORE FILLING GASOLINE TANK.

1. Fill gas tank with a good grade of fresh, clean UNLEADED REGULAR GASOLINE. Do not use gasoline that has been stored for any great length of time or has been sitting in some old gas can for a long while. LEADED REGULAR GASOLINE is an acceptable substitute. DO NOT USE HIGH OCTANE, PREMIUM GASOLINE, OR GASOHOL.

CAUTION: Experience indicates that alcohol blended fuels (called gasohol or using ethanol or methanol) can attract moisture which leads to separation and formation of acids during storage. Acidic gas can damage the fuel system of an engine while in storage.

To avoid engine problems, the fuel system should be emptied before storage for 30 days or longer. Drain the gas tank, start the engine and let it run until the fuel lines and carburetor are empty. Use fresh fuel next season. See Storage Instructions for additional information.

Never use engine or carburetor cleaner products in the fuel tank or permanent damage may occur.

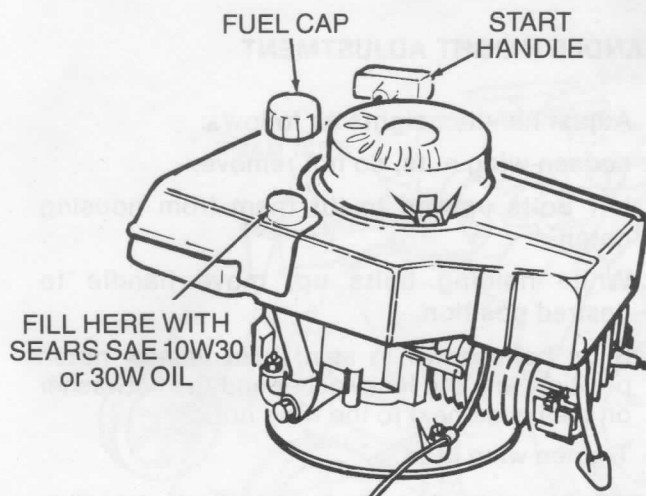

MODEL 113.797831

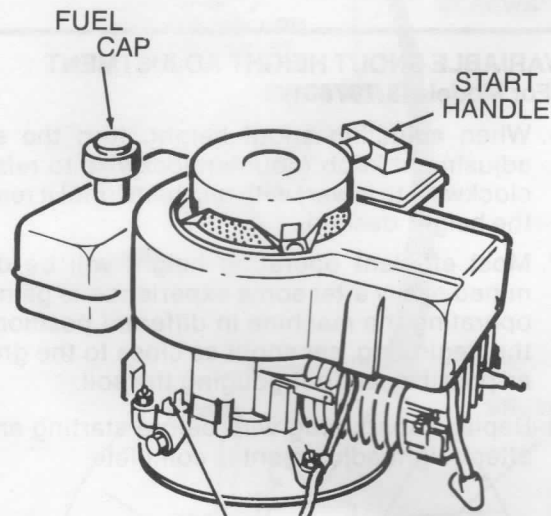

MODEL 113.796812

PRIMING THE ENGINE WITH PRESTARTING PRIMER

1. Move Control Lever on engine to "Fast".
2. Push Prestarting Primer button 2 or 3 times.

NOTE: Wait about 2 seconds between each push.

NOTE: In temperatures 50°F or below push button 5 times.

CAUTION: Do not use pre-starting primer to restart a warm engine after a short shutdown.

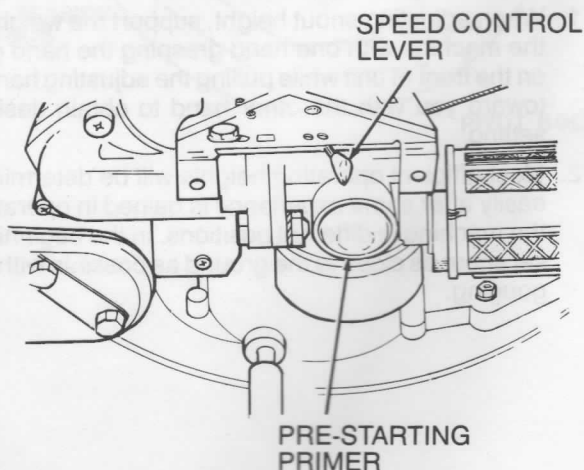

TO START ENGINE

WARNING: Before starting engine, be sure shredder grille, elbow and bag, or blower deflector are securely in place.

NOTE: For your safety this machine is equipped with an interlock system so that the engine will not start or run, unless the elbow and bag or blower deflector is in place. Do not use this machine if the interlock is not functioning correctly.

1. To start engine after priming, grasp starter handle and pull sharply (as shown). Do not allow starter rope to snap back. Rewind slowly keeping hold of the starter handle at all times.
2. After engine starts, adjust the control to the speed you need.

TO STOP ENGINE

To stop your engine, move the control knob to the "STOP" position.

operating instructions

POWER BRUSH OPERATION (MODEL 113.797831 ONLY)

1. A power brush is attached underneath the snout of the vacuum-shredder-bagger-blower. This brush helps to pick up wet leaves, dead grass and pine needles that settle in lawns and grassy areas. Remove shredder grille for best results.
2. For maximum performance, periodically check the brush for debris clinging to the bristles. Shut off engine. Remove spark plug wire and slightly tilt the machine back to get to the brush.
3. To do a thoroughly good job of cleaning pine needles from a grassy area, go over the area twice, one time in one direction then the opposite way the second time.
4. In general, the machine will handle any lawn material which it picks up. Avoid picking up visible metal objects, heavy fibrous material, or pieces of cloth which will require shutdown and manual removal.

NOTE: Do not attempt to pick up vines, or any other stringy material, as this may result in brush damage.

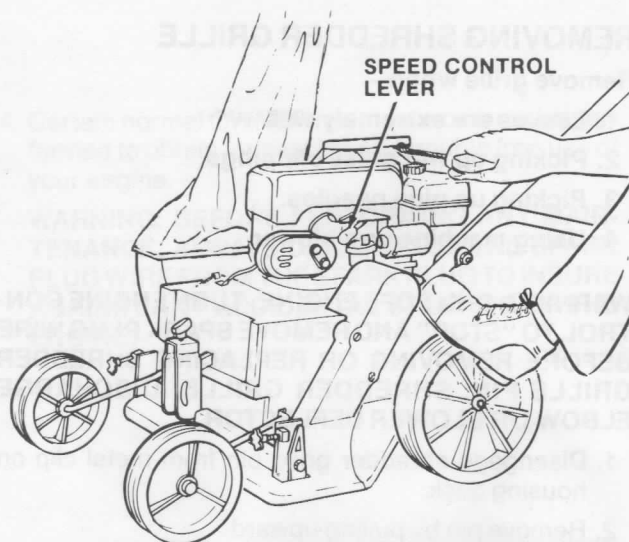

(MODEL 113.797831 Shown)

EMPTYING BAG

WARNING: Shut the engine off and wait until the impeller comes to a complete stop before emptying bag.

To empty bag shut off engine and perform the following procedures:

1. While holding bottom of the shredder bagger bag, loosen the tie strings attached to the bag.
2. Place the bottom of the shredder bag into a Sears disposable heavy duty lawn and garden bag. Empty all contents into the bag.
3. Regather and tie Vacuum Shredder Bagger bag securely.

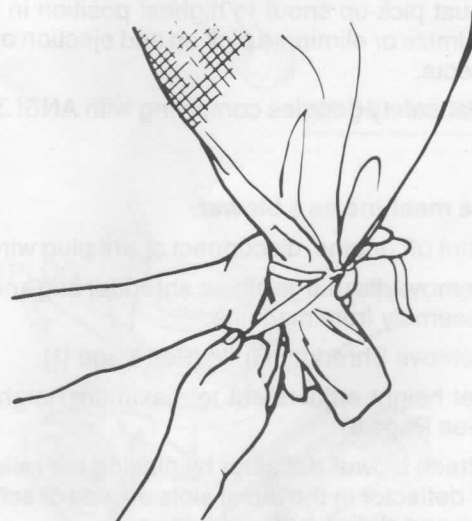

REMOVING SHREDDER GRILLE

Remove grille when—

1. Leaves are extremely wet.
2. Picking up wet grass clippings.
3. Picking up pine needles.
4. Using machine as a blower.

WARNING: SHUT OFF ENGINE, TURN ENGINE CONTROL TO "STOP" AND REMOVE SPARK PLUG WIRE BEFORE REMOVING OR REPLACING SHREDDER GRILLE PIN, SHREDDER GRILLE, DISCHARGE ELBOW OR BLOWER DEFLECTOR.

1. Disengage shredder grille pin from metal clip on housing deck.
2. Remove pin by pulling upward.
3. Grasp shredder grille by tab and pull outward.
4. Reinstall shredder grille pin to avoid loss.
5. Reinstall discharge elbow or blower.

Clean out the grille seat prior to replacement (See page 17). Replace grille immediately after operation(s) noted above are completed.

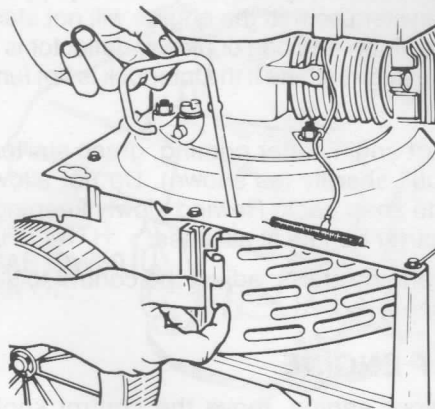

USING MACHINE AS A BLOWER

1. To aid in pick up of extremely wet leaves.
2. To lift leaves from turf to speed drying for later shredding and pick up.
3. To dislodge lawn debris around bushes, fences or buildings.

WARNING: OBSERVE FOLLOWING RULES FOR SAFE OPERATION AS A BLOWER.

- Always use blower deflector.
- Adjust pick-up snout to highest position in order to minimize or eliminate pick up and ejection of foreign objects.
- Wear safety goggles complying with ANSI Z87.1

To use machine as a blower:

1. Shut off engine, disconnect spark plug wire.
2. Remove discharge elbow, shredder bag and hanger assembly from machine.
3. Remove Shredder Grille (See Page 11).
4. Set height adjustment to maximum height setting (See Page 9).
5. Attach blower deflector by placing the rails on side of deflector in the top of slots on side of scroll housing and sliding it straight down.
6. After ensuring that the blower/deflector is fully seated in the slots of the scroll housing, secure it by looping the safety interlock spring over the tab.

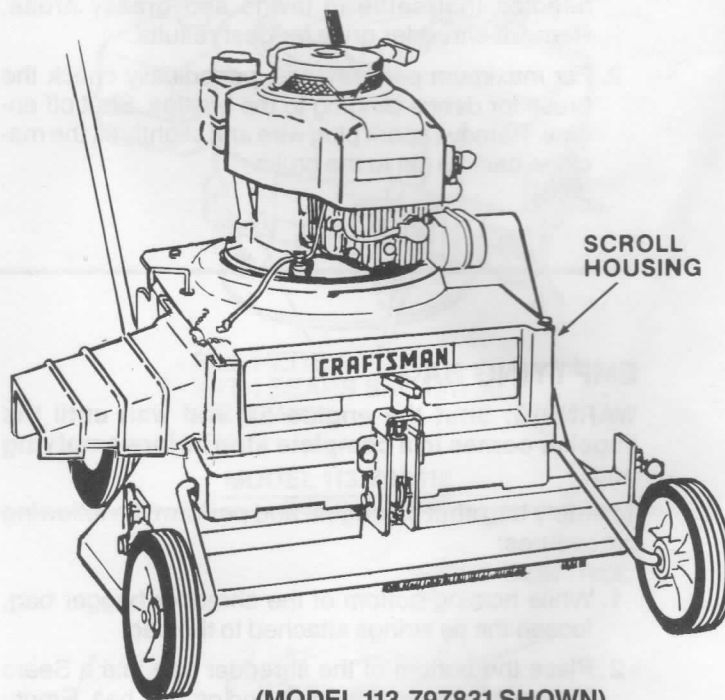

(MODEL 113.797831 SHOWN)

CAUTION! For your safety, this tool is equipped with an ignition interlock. The engine will not start or run if the safety interlock spring is not in place over the plastic tab of the elbow. If the engine does not stop when the spring is removed from the plastic tab, or if the interlock does not work for any other reason, DO NOT operate this tool. Contact Sears for service and have it repaired before using.

service instructions

GENERAL

1. Just as your automobile needs professional mechanical maintenance from time to time, so does your air cooled engine. Periodic replacement of the spark plug and ignition points is made necessary by NORMAL use.
2. Professional air cooled engine service is as close as your nearest SEARS STORE.
3. A yearly check-up or tune-up by Sears is a good idea to avoid breakdowns or delays. Do it at the end of the season, then you're ready for the next season.

4. Certain normal OWNER maintenance must be performed to obtain longest life and trouble free use of your engine.

WARNING: BEFORE PERFORMING ANY MAINTENANCE, ALWAYS DISCONNECT THE SPARK PLUG WIRE FROM THE SPARK PLUG TO INSURE AGAINST ANY ACCIDENTAL STARTING OF THE ENGINE.

OIL CHANGING

1. You must change the oil in the crankcase after the first two (2) hours of operation of your new engine and after every 25 hours of use thereafter. This will insure proper lubrication of internal parts for trouble-free operation and prevent costly repairs due to excessive wear. **CHANGE THE OIL MORE FREQUENTLY IF USED IN SANDY OR DUSTY CONDITIONS.**
2. Check oil level before each use of Shredder Bagger and add oil as necessary to bring up to proper level.
3. Oil should also be changed at the start of each season.

WARNING: Disconnect spark plug wire from spark plug and place it where it cannot come in contact with spark plug.

4. To change oil:
 - a. Remove bag and elbow.
 - b. Loosen and remove drain plug at base of oil fill hole.
 - c. Tilt Shredder Bagger on side allowing old oil to drain into container.
 - d. Rock Shredder Bagger back and forth to remove any oil that may be trapped in engine.
 - e. Reinstall drain plug.
 - f. Fill with 15 ounces Model 113.797831 and 21 ounces for 113.796812 of SAE10W30 or 30W oil. Then check dipstick and add more oil if required.

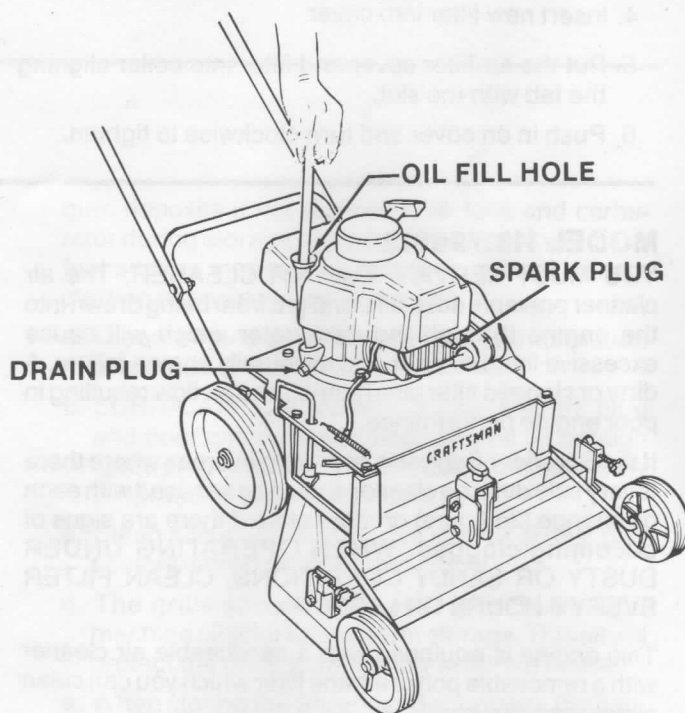

MODEL 113.797831

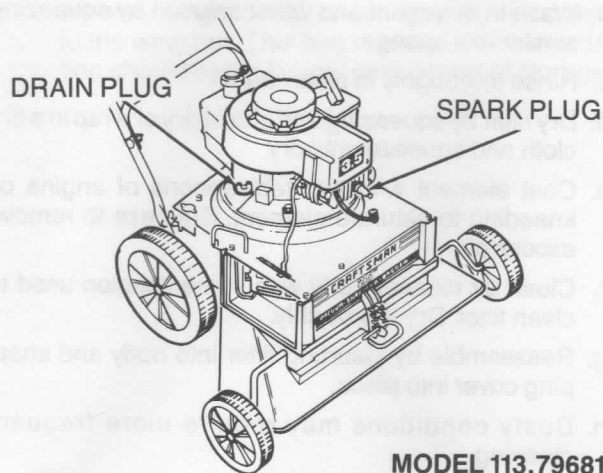

MODEL 113.796812

SERVICE AIR FILTER MODEL 113.797831

CAUTION: Do not run your engine without Air Filter in place.

1. Engine will not run properly with a clogged, dirty air filter.
2. Replace air filter each year, more often if using in very dusty, dirty conditions.

NOTE: DO NOT WASH THIS TYPE AIR FILTER.

To Change Air Filter:

1. Remove air filter cover by turning counter-clockwise to the stop and pull away from collar.
2. Remove the filter from inside of cover.
3. Clean the inside of the cover and the collar to remove any dirt accumulation.
4. Insert new filter into cover.
5. Put the air filter cover and filter into collar aligning the tab with the slot.
6. Push in on cover and turn clockwise to tighten.

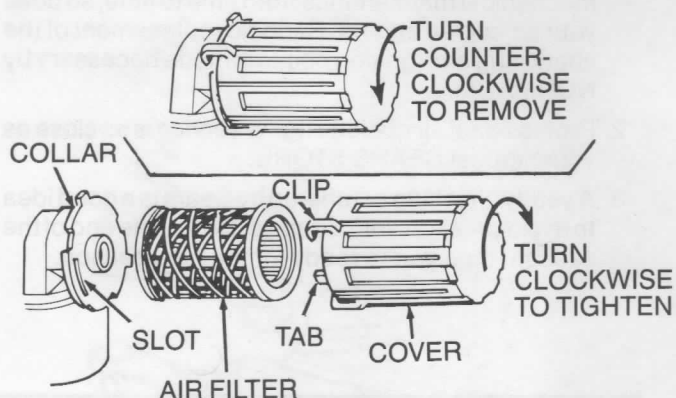

MODEL 113.796812

YOU MUST SERVICE THE AIR CLEANER. The air cleaner prevents dust, dirt, and grit from being drawn into the engine through the carburetor which will cause excessive internal wear and eventually engine failure. A dirty or clogged filter also restricts the air flow resulting in poor engine performance.

If the Shredder Bagger is operating in areas where there is very little dust the cleaner should be serviced with each oil change (25 hours) or more often if there are signs of becoming clogged. **WHEN OPERATING UNDER DUSTY OR SANDY CONDITIONS, CLEAN FILTER EVERY 8 HOURS OR LESS.**

This engine is equipped with a serviceable air cleaner with a removable polyurethane filter which you can clean simply as follows:

To remove air cleaner cover, grasp tab and lift off.

- a. Remove polyurethane filter.
- b. Wash in detergent and water solution by squeezing similar to a sponge.
- c. Rinse thoroughly in clean water.
- d. Dry filter by squeezing and shake dry or wrap in a dry cloth and squeeze until dry.
- e. Coat element with two tablespoons of engine oil kneading to saturate element. Squeeze to remove excess oil.
- f. Clean air cleaner body with same solution used to clean filter. Dry thoroughly.
- g. Reassemble by inserting filter into body and snapping cover into place.
- h. Dusty conditions may require more frequent cleaning.

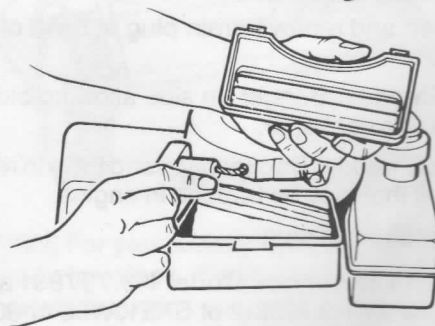
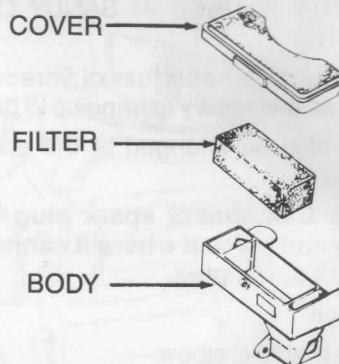

CHECK SPARK PLUG

1. Remove the spark plug each time you change oil and inspect it.
 - a. The electrode should be kept clean and free of carbon. The presence of carbon or excess oil will greatly decrease engine performance.
 - b. To clean electrode, carefully scrape it until entire spark plug is clean.
 - c. Check the spark plug gap using a wire feeler gauge. This specification should be .030.
2. If you need a new Spark Plug, refer to the parts list for the proper replacement Spark Plug.
3. Before installing Spark Plug, coat threads lightly with Graphite Grease if possible to insure easy removal next time the Spark Plug needs inspection and clean area around spark plug base.

ELECTRODE

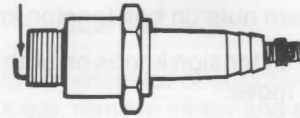

STORAGE INSTRUCTIONS

WARNING: ALLOW ENGINE TO COOL BEFORE STORING.

1. Never store your machine where fumes from fuel in the gas tank may reach sparks or an open flame.
2. In the event machine is to be stored for any length of time (30 days or longer) or at the end of each season, prepare as follows:
 - a. DO NOT SAVE or store gasoline for extended periods of time.

It is important to prevent gum deposits from forming in essential fuel system parts such as the carburetor, fuel filter, fuel hose, or tank during storage. Also, experience indicates that alcohol blended fuels (called gasohol or using ethanol or methanol) can attract moisture which leads to separation and formation of acids during storage. Acidic gas can damage the fuel system of an engine while in storage.

To avoid engine problems, the fuel system should be emptied before storage of 30 days or longer. Follow these instructions:

1. DRAIN GAS TANK.
2. DRAIN CARBURETOR by allowing engine to run out of gasoline. Evaporating gasoline will leave

gum deposits if not drained from tank and carburetor during storage periods. This deposit will make fuel system inoperative, resulting in hard or non-starting of engine when again used.

- a. Clean engine before storing. See information under "SERVICE INSTRUCTIONS".
- b. LUBRICATE CYLINDER. Remove spark plug and pour one ounce of clean engine oil through spark plug hole into cylinder. Crank engine slowly to spread oil and replace spark plug.
- c. Clean accumulated dirt from interior of unit, particularly shredder grille and elbow.
- d. The grille should be coated with Sears light machine oil prior to long term storage. This oil will protect the grille from rusting while not in use.
- e. When storing the Shredder Bagger with the handle in the full upright position, it is not necessary to permanently secure the handle with both wing nuts. However, if this is desirable, the bag assembly with hanger could be removed to gain access to the wing nut. This bag removal recommendation should apply for any long period of storage.

BRUSH REPLACEMENT (MODEL 113.797831)

WARNING: REMOVE SPARK PLUG WIRE WHEN WORKING WITH VACUUM-SHREDDER-BAGGER-BLOWER MACHINE.

1. Remove belt guard by removing 2 Phillips head machine screws that attach it to the housing.
2. Loosen jam nuts on belt tension knob shafts.
3. Loosen belt tension knobs on both sides until brush is free to move.
4. Remove 5/16-18 x 1 bolt holding brush support arm on left side of machine.
5. Loosen 5/16-18 x 1 bolt holding brush support on right side of machine.
6. Tip machine back to reveal power brush, rotate and remove the left brush support arm from the brush.
7. Remove belt from brush, pull brush from the right brush support arm, and discard.
8. Remove and replace bushing from each brush support arm if necessary.

NOTE: Remove bushings and clean; then place a few drops of oil on each bushing.

9. Slide 2 washers then the brush through belt and insert into right brush support arm.
10. Slip belt into slot and slide 2 washers on brush then replace left brush support arm onto brush.
11. Insert left brush support arm through opening in housing and install 5/16-18 x 1 bolt until finger tight. Bring machine forward.
12. Adjust belt tension by turning belt tension knob until brush is tight.

NOTE: To check tightness squeeze together the two sides of belt. There should be 1/2" gap (see page 8).

13. Tighten the jam nut and 5/16-18 x 1 on each brush support arm.
14. Replace belt guard with two (2) Phillips head machine screws, spacers and lockwashers.

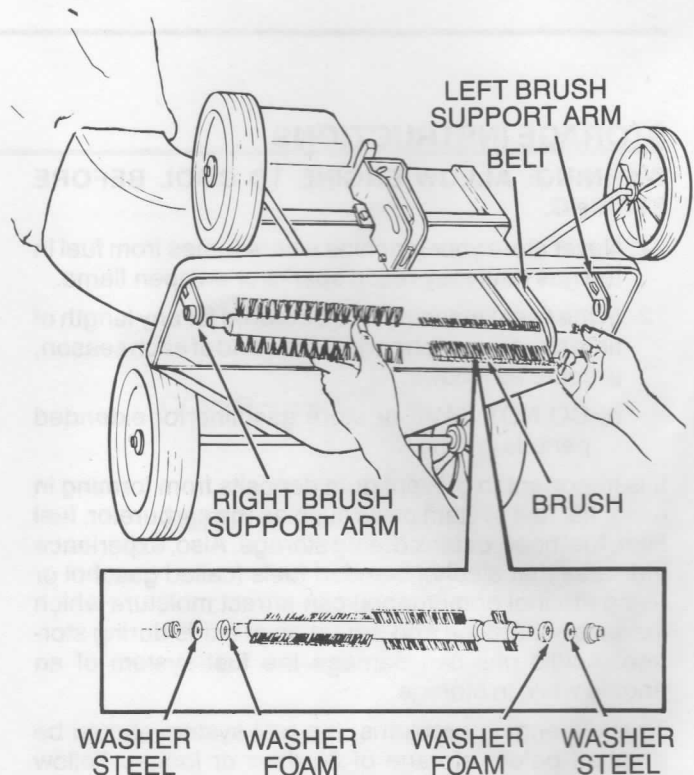
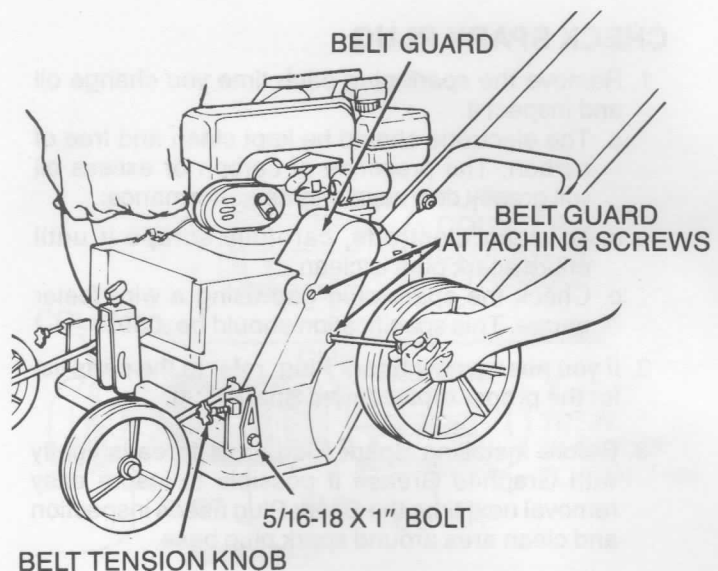

DRIVE BELT REPLACEMENT (MODEL 113.797831)

1. Remove power brush following the instructions for brush replacement.
2. Loop new belt over pulley and brush.
3. Replace brush into brush support arm and bolt the support arms loosely to the machine.
4. Adjust belt tension by pushing backward on brush support arm then tighten the belt tension knob.
5. Replace belt guard with the two screws.

trouble shooting

WARNING: ALWAYS SHUT OFF ENGINE AND DISCONNECT SPARK PLUG WIRE BEFORE TROUBLE SHOOTING.

TROUBLE	PROBABLE CAUSE	REMEDY
Loss of pick-up action.	<ol style="list-style-type: none"> 1. Clogged snout, discharge elbow, shredding chamber or shredder grille. 2. Full bag. 	<ol style="list-style-type: none"> 1. a. Check inside of snout for obstructions. b. If snout is clear, remove elbow and check for obstructions. c. If elbow is clear, pull grille pin, and remove grille for access to shredding chamber. Remove clogged material from grille or shredding chamber. d. Clean out housing slot with grille pin if necessary. Replace grille. (See Fig. 1 Page 12.) 2. Check contents of bag to determine if full.
Persistent clogging of grille.	<ol style="list-style-type: none"> 1. Clearance of grille-to-fan greater than 1.32" . 	<ol style="list-style-type: none"> 1. Reset clearance of grille-to-fan if greater than 1/32" (as shown in Fig. 2 Page 12). 18
Brush not rotating. (113.797831 only)	<ol style="list-style-type: none"> 1. Jammed brush. 2. Loose or damaged belt. 3. Belt off pulley. 4. Dirty bushings. 	<ol style="list-style-type: none"> 1. Remove obstructions. 2. Tighten or replace belt. See instructions on page 15. 3. Make sure belt is securely on pulley. 4. Remove bushings and clean. Then place a few drops of oil on each bushing.
Engine won't start or is hard to start.	<ol style="list-style-type: none"> 1. Out of gas or inadequate supply. 2. Spark plug wire disconnect from plug. 3. Spark plug porcelain cracked. 4. Spark plug fouled. 5. Gas line obstructed. 6. Dirty, stale, water-contaminated gas. 7. Flooded engine. 8. Dirty or plugged air cleaner. 9. Fuel is gasohol. 10. Elbow or blower deflector not attached. 	<ol style="list-style-type: none"> 1. Fill gas tank. 2. Connect spark plug wire to spark plug. 3. Replace spark plug. 4. Clean electrode and reset plug gap. See instructions under "Check Spark Plug" in this manual. 5. Remove gas line at carburetor and check for obstruction. Drain gas tank and replace with a clean, fresh unleaded gasoline. 6. Drain gas tank and replace with a clean, fresh unleaded gasoline. 7. Put throttle in run position and crank several times to clear out the excess gas. 8. Clean air cleaner per instructions under "Service Air Cleaner" in this manual. 9. Drain gas tank and refill with non gasohol fuel. 10. Make sure safety interlock spring is looped over the tab on the discharge elbow or blower deflector.
Uneven pick-up of loose debris (113.797831 only)	<ol style="list-style-type: none"> 1. Brush adjustment is uneven. 	<ol style="list-style-type: none"> 1. Adjust brush and belt tension as described on page 8.

TROUBLE	PROBABLE CAUSE	REMEDY
Engine misses or lacks power under load	<ol style="list-style-type: none"> 1. Spark plug fouled 2. Water or oil in the gas 3. Not enough oil in crankcase 4. Clogged air cleaner 	<ol style="list-style-type: none"> 1. Clean and gap plug per instructions under "Check Spark Plug" in this manual. 2. Drain gas tank and replace with a clean, fresh unleaded gasoline. 3. Fill crankcase with oil or change oil per instructions under "Engine Lubrication" in this manual. 4. Clean air cleaner per instructions under "Service Air Cleaner" in this manual.
Engine overheats	<ol style="list-style-type: none"> 1. Low oil level or dirty oil in crankcase 2. Plugged muffler 3. Engine cooling, fins clogged 	<ol style="list-style-type: none"> 1. Fill crankcase with oil or change oil per instructions under "Engine Lubrication" in this manual. 2. Clean muffler surface with stiff brush (NOTE: Be sure muffler is cool before cleaning). 3. Blow accumulated dirt, dust and grass clippings from engine cooling fins.
Loud clanging noise coming from the scroll housing after machine is running (see Fig. 1 & Fig. 2).	<ol style="list-style-type: none"> 1. Fan striking Grille 	<p>WARNING: MAKE SURE SPARK PLUG WIRE HAS BEEN REMOVED FROM SPARK PLUG TO AVOID INJURY FROM ACCIDENTAL STARTING.</p> <ol style="list-style-type: none"> 1. Loosen the two 3/8 bolts on the Right Hand side of the machine just behind discharge area (as shown). Fig. 2. 2. Slide grille attachment bracket and grille in or out to obtain minimum clearance from fan blade top and bottom. 3. Tighten the two 3/8 bolts; be careful not to move bracket when tightening. 4. Pull starter rope slowly to check for striking of impeller against grille. (A light ticking noise is acceptable since grille is moved away from impeller by force of air).

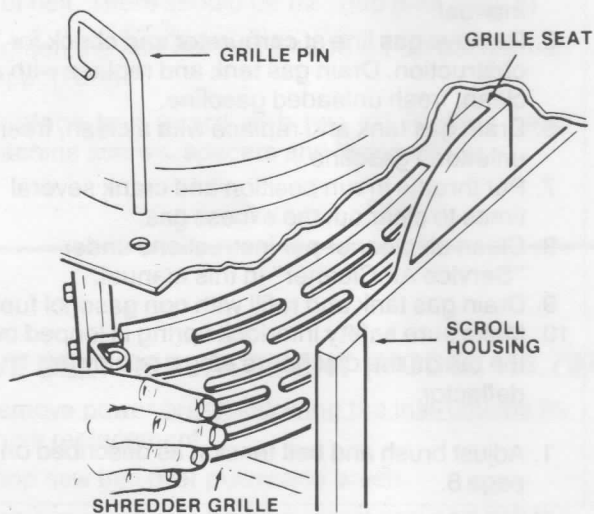

FIG. 1

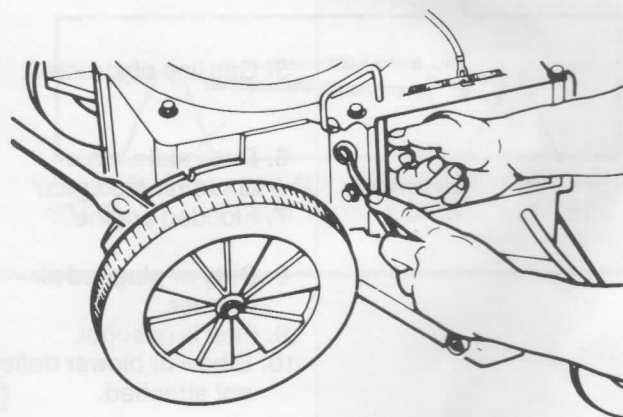
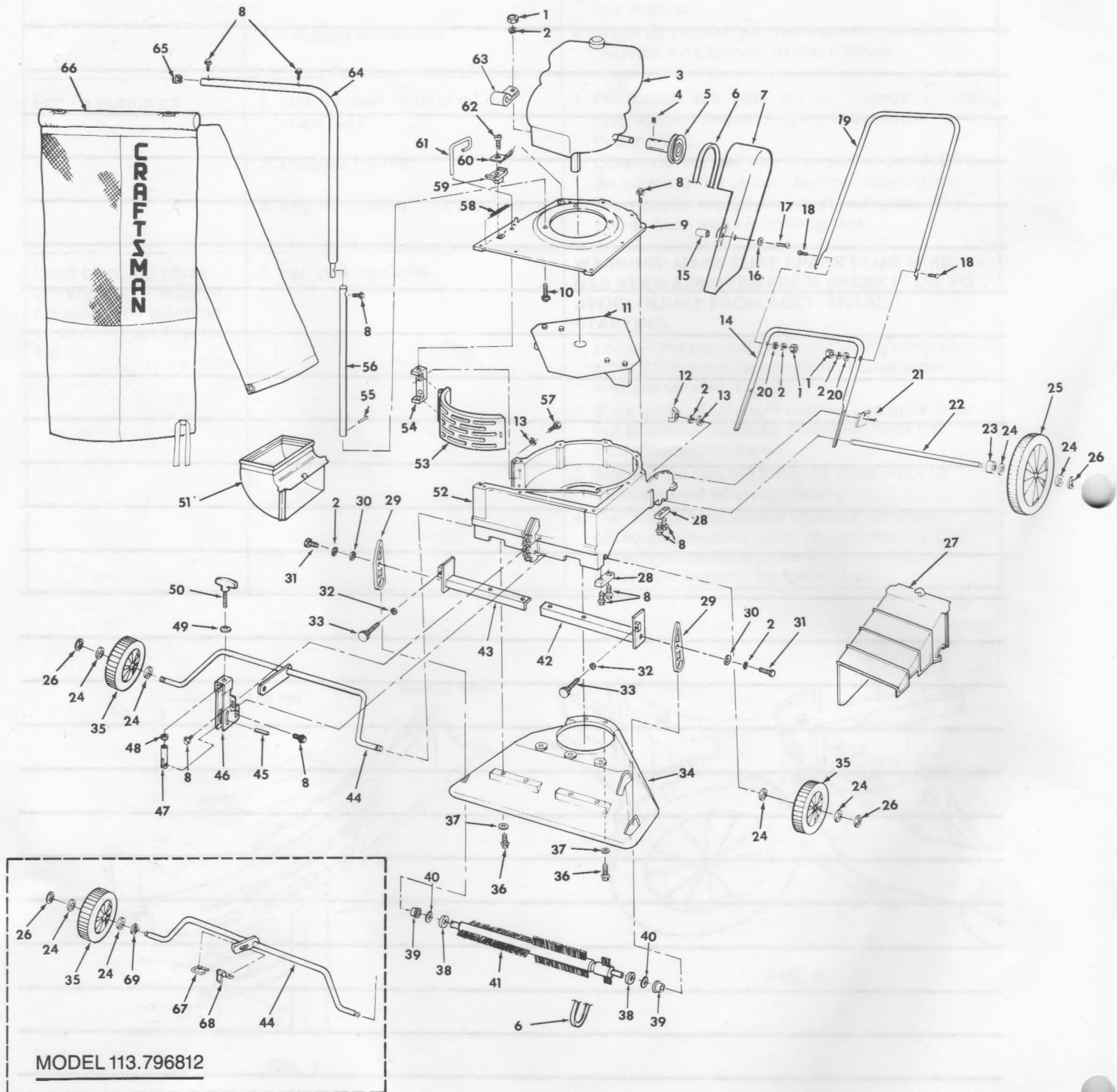

FIG. 2

repair parts

PARTS LIST FOR VACUUM-SHREDDER-BAGGER-BLOWER MODEL NO. 113.797831 & 113.796812



PARTS LIST FOR VACUUM-SHREDDER-BAGGER-BLOWER **MODEL NO. 113.797831 & 113.796812**

Always order by Part Number—Not by Key Number

Key No.	Part Number Model No.		Description
	113.796812	113.797831	
1	STD541031	STD541031	*Nut, Hex 5/16-18
2	STD551131	STD551131	*Lockwasher, 5/16
3	143.384552	143.384562	Engine, Model
4	—	STD502502	*Screw, Cup Pt. Set 1/4-20 x 5/16
5	—	816794	Pulley, Drive
6	—	816788	Belt
7	—	816802	Guard, Belt
8	273229	273229	Screw, Hex Ind. Washer Hd., 1/4-20 x 1/2
9	508177	508177	Plate, Engine Mounting
10	STD523112	STD523112	*Screw, Hex Hd., 5/16-18 x 1-1/4
11	809311	809311	Fan Assembly
12	STD541631	STD541631	*Nut, Wing 5/16-18
13	STD551037	STD551037	*Washer, .380 x 3/4 x 3/32
14	804545	804545	Support, Handle
15	—	802392-18	Spacer, 1/4 x 1-3/8
16	—	STD551125	*Lockwasher, 1/4
17	—	STD512520	Screw, Pan Hd. 1/4-20 x 2
18	STD533115	STD533115	*Bolt, Carriage 5/16-18 x 1-1/2
19	804547	804547	Handle, Push
20	60422	60422	Washer, Saddle
21	804555	804555	Bracket, Handle
22	804546	804546	Rod, Rear Axle
23	804296	804296	Spacer
24	STD551050	STD551050	*Washer, 1/2 x 1-1/8 x 1/16
25	809862	809862	Wheel, 10-Inch
26	STD581050	STD581050	*Ring, Retaining
27	804551	804551	Deflector
28	804172	804172	Strap, Axle
29	—	816795	Arm, Brush Mounting
30	—	STD551031	*Washer, 21/64 x 5/8 x 1/16
31	—	STD523110	*Screw, Hex Hd. 5/16-18 x 1
32	—	STD541025	*Nut, Hex 1/4-20
33	—	814103	Knob, Belt Tension
34	506476	507812	Snout Assembly

Key No.	Part Number Model No.		Description
	113.796812	113.797831	
35	809861	809861	Wheel, 6-Inch
36	STD522507	STD522507	*Screw, Hex Hd. Type "T" 1/4-20 x 3/4
37	—	STD551025	Washer, 17/64 x 5/8 x 1/16
38	—	818857	Washer, Foam
39	—	816787	Bushing, Flanged
40	—	STD551050	*Washer, .505 x 1-1/8 x 1/16
41	—	816796	Brush, Bristle
42	—	816799	Bracket, Brush Support L.H.
43	—	816800	Bracket, Brush Support R.H.
44	804561	816801	Rod, Front Axle
45	—	803422-134	Pin, Roll 5/32 x 1
46	—	816797	Bracket, Height Adjustment
47	—	816789	Rod, Adjusting
48	—	STD541431	*Nut, Lock 5/16-18
49	—	191221-6	Washer, 5/16 x 7/8 x 1/16
50	—	816790	Knob
51	804550	804550	Elbow, Discharge
52	804553	804553	Housing, Scroll
53	809260	809260	Grille
54	804544	804544	Bracket, Adjusting
55	STD572512	STD572512	*Pin, Roll 1/4 x 1-3/8
56	804163	804163	Support, Hanger
57	STD523710	STD523710	*Screw, Hex Hd. 3/8-16 x 1
58	804577	804577	Spring
59	818860	818860	Grommet
60	818859	818859	Terminal
61	804556	804556	Pin, Grille
62	813796-1	813796-1	*Screw, Pan Hd. Type "B" Stainless Steel #8 x 3/8
63	809739-3	809739-3	Clamp, Cable
64	804164	804164	Hanger, Bag
65	803185-2	803185-2	Cap, Tube
66	71-85681	71-85681	†Bag — REPLACEMENT 806008
67	804180	—	Ring, Pull
68	804181	—	Spring
69	804182	—	Ring, Retaining
	508175	508175	Bag of Loose Parts (Not Illus.)
	SP5323	SP5323	Owners Manual (Not Illus.)

*Standard Hardware Item may be Purchased Locally.

†Stock Item—May be secured through the Hardware Department of most Sears Retail Stores or Catalog Order Houses.

CRAFTSMAN 4-CYCLE ENGINE

MODEL NUMBER: 143.384562
FOR MODEL 113.797831

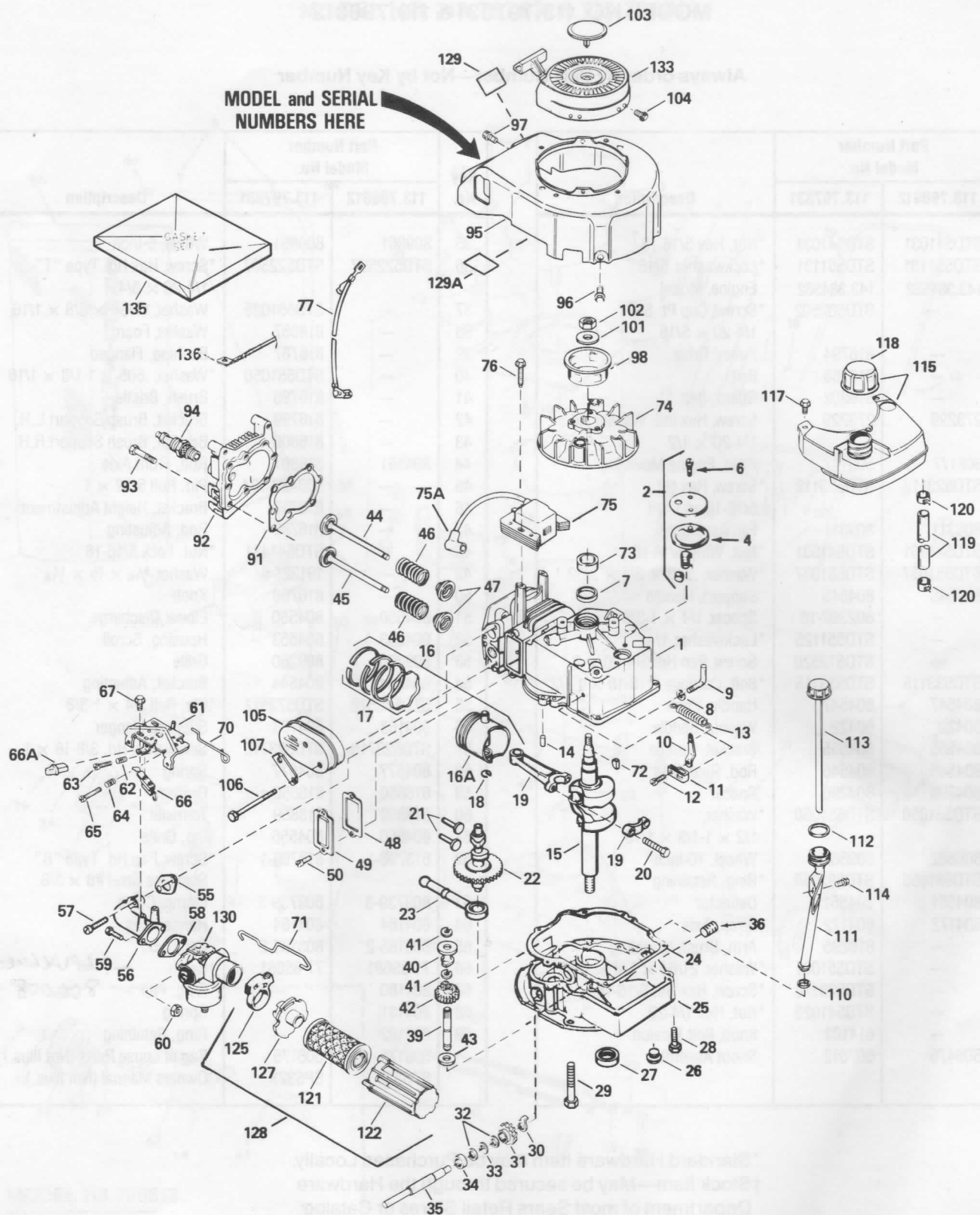

CRAFTSMAN 4-CYCLE ENGINE

MODEL NUMBER: 143.384562
FOR MODEL 113.797831

Ref. No.	Part No.	Part Name	Ref. No.	Part No.	Part Name
1	34950	Cylinder Assy. (Incl. Nos. 2, 4, 6, 7 & 14)	60	29752	Nut & Lockwasher, 1/4-28
2	34215	Breather Assy. (Incl. Nos. 4 & 6)	61	33205A	Bracket Assy., Control (Incl. Nos. 62 thru 65)
4	*32760	Gasket, Breather	62	33802	Spring, Compression
6	30200	Screw, Hex washer hd. self-tap Sems, 10-24 x 9/16	63	650777	Screw, Fil. hd., 6-32 x 21/32
7	32600	Seal, Oil	64	31342	Spring, Compression
8	28277	Washer, Flat	65	650549	Screw, Fil. hd., 5-40 x 7/16
9	31513	Rod, Governor	66	610973	Terminal Assy.
10	31383A	Lever, Governor	66A	32410	Knob, Control
11	31335	Clamp, Governor lever	67	30200	Screw, Hex washer hd. self-tap Sems, 10-24 x 9/16
12	650548	Screw, Hex washer hd., 8-32 x 5/16	70	34337	Link, Governor spring
13	31361	Spring, Extension	71	34336	Link, Throttle
14	26727	Pin, Dowel	72	611004	Key, Flywheel
15	35573	Crankshaft Assy.	73	34080	Spacer, Flywheel key
16	35544	Piston, Pin & Ring Assy. (Std.) (Incl. Nos. 16A, 17 & 18)	74	611112	Flywheel
16	35545	Piston, Pin & Ring Assy. (.010 over-size) (Incl. Nos. 16A, 17 & 18)	75	34443A	Solid State Assy.
16	35546	Piston, Pin & Ring Assy. (.020 over-size) (Incl. Nos. 16A, 17 & 18)	75A	610118	Cover, Spark plug
16A	35541	Piston & Pin Assy. (Std.) (Incl. No. 18)	76	650814	Screw, Hex hd. Sems, 10-24 x 1
16A	35542	Piston & Pin Assy. (.010 over-size) (Incl. No. 18)	77	34231	Wire, Ground
16A	35543	Piston & Pin Assy. (.020 over-size) (Incl. No. 18)	91	*32643	Gasket, Cylinder head
17	35547	Ring Set, Piston (Std.)	92	34335	Head, Cylinder
17	35548	Ring Set, Piston (.010 over-size)	93	6021A	Screw, Hex flange hd., 5/16-18 x 1-1/2
17	35549	Ring Set, Piston (.020 over-size)	94	35395	Spark Plug, Resistor (Champion RJ-19LM or equivalent)
18	20381	Ring, Piston pin retaining	95	35393	Housing, Blower
19	30963B	Rod Assy., Connecting (Incl. No. 20)	96	650831	Screw, Hex washer hd. Powerlok thread, 1/4-20 x 15/32
20	32610A	Bolt, Connecting rod	97	30200	Screw, Hex washer hd. self-tap Sems, 10-24 x 9/16
21	27241	Valve, Lifter	98	35000	Hub, Starter
22	33553	Camshaft (Mech. Compression Release)	101	650815	Washer, Belleville
23	29914	Pump Assy., Oil	102	650816	Nut, Flywheel
24	*35261	Gasket, Mounting flange	103	35392	Plug, Starter
25	33535B	Flange, Mounting (Incl. Nos. 26, 27, 34 & 39)	104	650884	Screw, Hex washer hd., 8-32 x 1/2
26	27244	Plug, Oil drain	105	34613	Muffler Assy.
27	26208	Seal, Oil	106	650795	Screw, Hex hd., 1/4-20 x 2-1/4
28	650488	Screw, Hex hd. Sems, 1/4-20 x 1-1/4	107	33753	Plate, Muffler locking
29	650492	Screw, Hex hd. Sems, 1/4-20 x 2-1/4	110	34265	Gasket, Fill tube
30	31745	Washer, Tang	111	35577	Tube, Oil fill
31	33401	Gear, Right hand worm	112	35499	"O" Ring
32	31747	Washer, Flat	113	35578	Dipstick, Oil fill
33	33537	Ring, Retaining	114	650562	Screw, Hex washer hd. shakeproof, 10-32 x 1/2
34	31744	Seal, Oil	115	34369A	Tank Assy. (Incl. Nos. 118 & 120)
35	33536	Shaft, P.T.O.	117	28763	Screw, Hex washer hd. shakeproof, 10-32 x 19/32
36	9556	Plug, Oil drain	118	35355	Cap, Fuel
39	30574	Shaft, Governor	119	30705	Line, Fuel
40	30588A	Spool, Governor	120	26460	Clamp, Fuel line
41	29193	Ring, Retaining	121	35066	Filter, Air cleaner
42	30591	Gear Assy., Governor (Incl. No. 43)	122	35065	Cover, Air cleaner
43	30590A	Washer, Flat	125	35068	Clamp, Air cleaner
44	29314B	Valve, Intake (Std.) (Incl. No. 47)	127	35067	Collar, Air cleaner
44	29315C	Valve, Intake (1/32" over-size) (Incl. No. 47)	128	3331	Air Cleaner Kit (Incl. Nos. 121, 122, 125 & 127)
45	29313C	Valve, Exhaust (Std.) (Incl. No. 47)	129	34346	Decal
45	29315C	Valve, Exhaust (1/32" over-size) (Incl. No. 47)	129A	35344	Decal, Instruction
46	31672	Spring, Valve	130	632389	Carburetor (Incl. No. 58)
47	31673	Cap, Lower valve spring	133	590635	Starter, Rewind
48	*27234	Gasket, Valve spring box	135	33236B	Gasket Set (Incl. items marked *)
49	32755	Cover, Valve spring box	136	818863	Wire, Ground
50	650128	Screw, Fil. hd. Sems, 10-24 x 1/2			
55	*34690	Gasket, Intake pipe			
56	31384A	Pipe, Intake (Incl. No. 55)			
57	650451	Screw, Hex hd. Sems, 1/4-20 x 1			
58	*26756	Gasket, Carburetor			
59	6201	Screw, Hex hd., 1/4-28 x 7/8			

*Indicates Parts Included in Gasket Set, Ref. No. 135.

RPM Speed Setting:
Low 2050; High 3150.

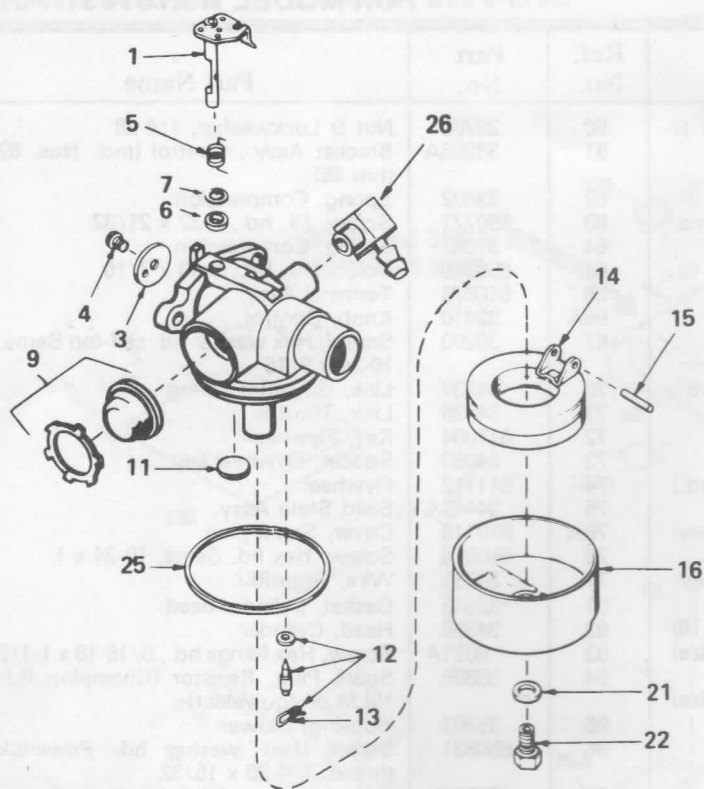

Ref. No.	Part No.	Part Name
	632389	Carburetor
1	631615	Shaft & Lever Assy., Throttle
3	631616	Shutter, Throttle
4	650506	Screw, Throttle shutter
5	631767	Spring, Throttle return
6	631971	Seal, Dust
7	631184	Washer, Flat
9	632047	Primer Assy.
11	631027	Plug, Welch
12	631021	Inlet Needle, Seat & Clip Assy. (Incl. No. 13)
13	631022	Clip, Inlet needle
14	632019	Float, Carburetor
15	631024	Shaft, Float
16	631700	Bowl, Float
21	631334	Gasket, Bowl-to-body
22	631935	Nut, Float bowl
25	631028	Gasket, Bowl-to-body
26	631775	Fitting, Fuel inlet

REWIND STARTER NO. 590635

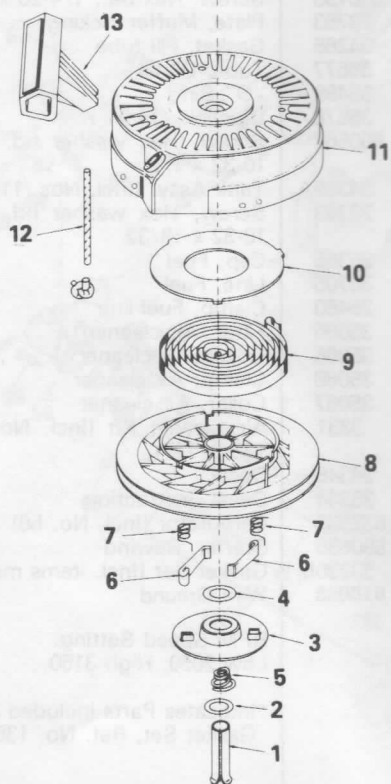

Ref. No.	Part No.	Part Name
	590635	Starter, Rewind
1	590599A	Pin, Spring (Incl. No. 4)
2	590600	Washer
3	590615	Retainer
4	590601	Washer
5	590598	Spring, Brake
6	590616	Dog, Starter
7	590617	Spring, Dog
8	590618	Pulley
9	590619	Spring, Rewind
10	590620	Cover, Spring
11	590622	Housing Assy., Starter
12	590535	Rope, Starter (Length 62" & 9/64" dia.)
13	590452	Handle, Starter

CARBURETOR NO. 632046

FOR MODEL 113.796812

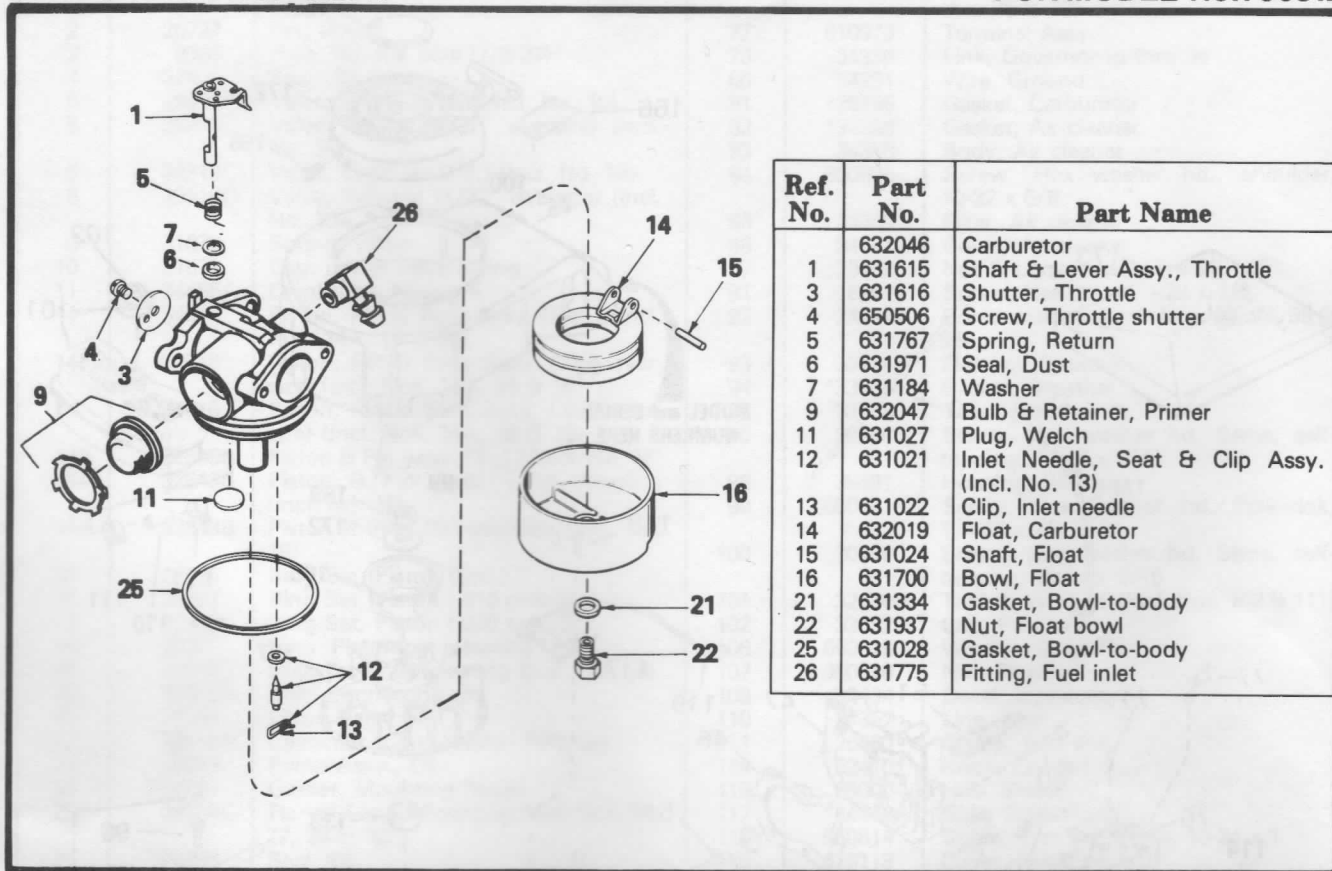

CONFIRMED AS DUE 7/19



CRAFTSMAN 4-CYCLE ENGINE

MODEL NUMBER: 143.384552
FOR MODEL 113.796812

Ref. No.	Part No.	Part Name	Ref. No.	Part No.	Part Name
1	34975	Cylinder Assy. (Incl. Nos. 2, 4, 94 & 96)	76	33205A	Control Assy., Speed (Incl. Nos. 72 thru 75 & 77)
2	26727	Pin, Dowel	77	610973	Terminal Assy.
3	9556	Plug, Sq. hd. pipe (1/8-27)	78	34336	Link, Governor-to-throttle
4	32600	Seal, Oil	80	34231	Wire, Ground
5	29314B	Valve, Intake (Std.) (Incl. No. 10)	81	*26756	Gasket, Carburetor
5	29315C	Valve, Intake (1/32" oversize) (Incl. No. 10)	82	*34338	Gasket, Air cleaner
6	29313C	Valve, Exhaust (Std.) (Incl. No. 10)	83	34858	Body, Air cleaner
6	29315C	Valve, Exhaust (1/32" oversize) (Incl. No. 10)	84	650806	Screw, Hex washer hd., shoulder, 10-32 x 5/8
9	31672	Spring, Valve	85	34340	Filter, Air cleaner
10	31673	Cap, Lower valve spring	86	34341A	Cover, Air cleaner
11	34455A	Crankshaft Assy.	87	29752	Nut & Lockwasher, 1/4-28
14	34514	Piston, Pin & Ring Assy. (Std.) (Incl. Nos. 14A, 15 & 16)	91	6201	Screw, Hex hd., 1/4-28 x 7/8
14	34515	Piston, Pin & Ring Assy. (.010 oversize) (Incl. Nos. 14A, 15 & 16)	92	34214A	Breather Assy. (Incl. Nos. 93, 94, 95 & 96)
14	34516	Piston, Pin & Ring Assy. (.020 oversize) (Incl. Nos. 14A, 15 & 16)	93	33734	Element, Breather
14A	32538B	Piston & Pin Assy. (Std.) (Incl. No. 16)	94	*33735	Gasket, Breather
14A	32548B	Piston & Pin Assy. (.010 oversize) (Incl. No. 16)	95	33886	Tube, Breather
14A	32549B	Piston & Pin (.020 oversize) (Incl. No. 16)	96	30200	Screw, Hex washer hd. Sems, self-tapping, 10-24 x 9/16
15	28986	Ring Set, Piston (Std.)	98	35491	Housing, Blower
15	28987	Ring Set, Piston (.010 oversize)	99	650831	Screw, Hex washer hd. Powerlok, 1/4-20 x 15/32
15	28988	Ring Set, Piston (.020 oversize)	100	30200	Screw, Hex washer hd. Sems, self-tapping, 10-24 x 9/16
16	20381	Ring, Piston pin retaining	101	32170A	Tank Assy., Fuel (Incl. Nos. 102 & 111)
17	30963B	Rod Assy., Connecting (Incl. No. 18)	102	33032	Cap, Fuel tank
18	32610A	Bolt, Connecting rod	106	650815	Washer, Belleville
21	27241	Lifter, Valve	107	650816	Nut, Flywheel
22	33148A	Camshaft (Compression Release)	108	34434	Decal, Instruction
23	29914	Pump Assy., Oil	110	34357	Line, Fuel
24	*35261	Gasket, Mounting flange	111	26460	Clamp, Fuel line
25	30784C	Flange Assy., Mounting (Incl. Nos. 26, 27, 28 & 32)	114	32410	Knob, Control
26	26208	Seal, Oil	115	35000	Hub, Starter
28	27244	Plug, Oil drain	117	34443A	Solid State Assy.
29	650488	Screw, Hex hd. Sems, 1/4-20 x 1-14	118	650814	Screw, Hex hd. Sems, 10-24 x 1
31	30590A	Washer, Flat	119	610118	Cover, Spark plug
32	30574	Shaft, Mechanical governor	120	27181B	Muffler Assy. (Incl. No. 121)
33	30591	Gear Assy., Governor (Incl. No. 31)	121	650795	Screw, Hex hd., 1/4-20 x 2-1/4
34	29193	Ring, Retaining	136	34080	Spacer, Flywheel key
35	30588A	Spool, Governor	137	611112	Flywheel
36	31335	Clamp, Governor lever	149	27625	Plug, Oil fill (Incl. No. 150)
37	28277	Washer, Flat	150	*29673	Gasket, Oil fill plug
38	30589	Rod, Governor (Incl. No. 37)	166	34346	Decal, Instruction
39	31383A	Lever, Governor	168	650884	Screw, Hex washer hd., 8-32 x 1/2
40	650548	Screw, Hex washer hd., 8-32 x 5/16	169	35392	Plug, Starter
42	611004	Key, Flywheel (Solid State)	170	632046	Carburetor (Incl. No. 81)
46	*29953C	Gasket, Cylinder head	172	590635	Starter, Rewind
47	34335	Head, Cylinder	173	33238C	Gasket Set (Incl. items marked *)
49	6021A	Screw, Hex flange hd., 5/16-18 x 1-1/2	174	818863	Wire, Ground
51	35395	Plug, Spark (Champion RJ-19LM or equivalent)			
52	*27234	Gasket, Valve spring cover			
53	32755	Cover, Valve spring box			
57	650128	Screw, Fil. hd. Sems, 10-24 x 1/2			
59	34690	Gasket, Intake pipe			
60	31384A	Pipe, Intake (Incl. No. 59)			
62	650451	Screw, Hex hd. Sems, 1/4-20 x 1			
66	31361	Spring, Governor			
70	34337	Link, Governor spring			
71	30200	Screw, Hex washer hd. Sems, self-tapping, 10-24 x 9/16			
72	33802	Spring, Compression			
73	31342	Spring, Compression			
74	650777	Screw, Fil. hd., 6-32 x 21/32			
75	650549	Screw, Fil. hd., 5-40 x 7/16			

RPM Settings:
Low Speed: 2050; High Speed: 3150

*Indicates Parts Included in
Gasket Set, Ref. No. 173.

SEARS

owners manual

SERVICE

MODEL NO.
113.797831
113.796812

HOW TO ORDER REPAIR PARTS

VACUUM - SHREDDER - BAGGER - BLOWER

Now that you have purchased your Vacuum-Shredder-Bagger should a need ever exist for repair parts or service, simply contact any Sears Service Center and most Sears, Roebuck and Co. stores. Be sure to provide all pertinent facts when you call or visit.

The model number of your Vacuum-Shredder-Bagger-Blower will be found at the Rear of the Housing.

**WHEN ORDERING REPAIR PARTS, ALWAYS
GIVE THE FOLLOWING INFORMATION:**

PART NUMBER	PART DESCRIPTION
--------------------	-------------------------

MODEL NUMBER	NAME OF ITEM
---------------------	---------------------

113.796812 OR	
113.797831	Vacuum-Shredder-Bagger-Blower
143.384562 OR	
143.384552	Engine

All parts listed may be ordered from any Sears Service Center and most Sears stores. If the parts you need are not stocked locally, your order will be electronically transmitted to a Sears Repair Parts Distribution Center for handling.

Sold by SEARS, ROEBUCK AND CO., Chicago, IL. 60684 U.S.A.